

FRONT VIEW

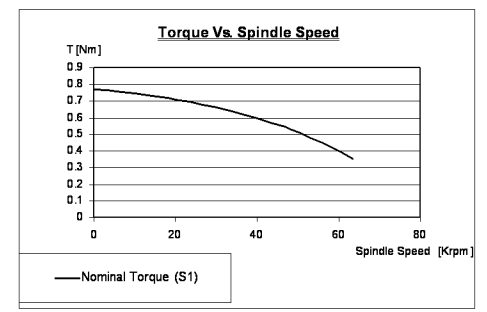
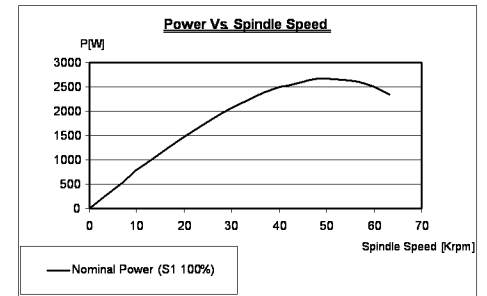
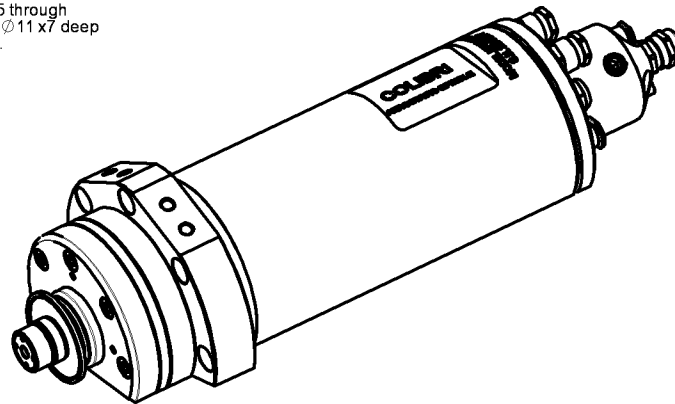
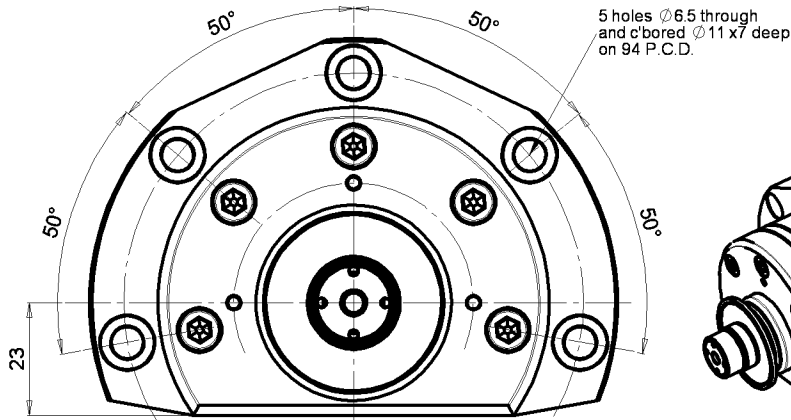

SPEC

air supply pressure	5.0 - 5.5 bar
air consumption	60 l/min @ 5.0 bar
radial load at P	130 N @ 5.0 bar
axial load	150 N @ 5.0 bar
maximum speed	60,000 r.p.m.
min cooling water flow	1.0 l/min
power output	2.4 Kw
motor	D.C. brushless
continuous stall torque	0.68 Nm
number of poles	6
spindle noise level	70 dB
spindle weight	7.3 kg

**AEROSTATIC
2" DICING SPINDLE
60,000 rpm
2400 W**

COLIBRI
Spindles Technology
Lavon Industrial Park,
M. P. Bikal Bet Hakerem
25127, Israel
Tel: 972-4-908-1304
Fax: 972-4-958-9061
www.colibrispindles.com

FRD-3-00-00-00		ASSEMBLY	
PART	DESCRIPTION		
PROJECT: AIR SPINDLE "HF 80 L13 D60"			
Dimensions in mm: Unless otherwise machined surfaces to be 1.6 micron (N7). Break all sharp edges 50.2 max or 0.2x45° chamfer			
FILE: W:\SWFroid\FRD-3-00-00	SCALE: 1:1	SHEET 1 OF 1	REV
DD	NEW	TANYA	29/01/04
REV	DESCRIPTION	NAME	DATE